



CROWNE PLAZA®

TIMES SQUARE MANHATTAN



Capacities Chart

Function Room	Theater	Conference	Classroom (3pp/6')	U Shaped	Reception	Banquet	Sq. Footage	Dimensions	Ceiling Height
Second Floor									
Times Square Ballroom	418	140	250	120	418	310	4,182	81'X51'	10'
Times Square A	147	49	90	42	148	110	1,479	23'X51'	10'
Times Square B	153	51	111	43	153	120	1,530	30'X51'	10'
Times Square C	117	39	69	33	117	70	1,173	23'X51'	10'
Balcony Room	N/A	N/A	N/A	N/A	205	150	2,057		10'-20'
Fourth Floor									
Broadway Ballroom	675	226	450	193	675	500	6,780	60'X113'	15'6"
Act I	180	60	114	51	180	140	1,800	60'X30'	15'6"
Act II	160	54	96	46	162	120	1,620	60'X27'	15'6"
Act III	155	52	90	45	156	100	1,560	60'X26'	15'6"
Act IV	180	60	114	51	180	140	1,800	60'X30'	15'6"
401/402	105	30	75	26	92	100	920	46'X20'	10'
401	50	15	36	13	46	40	460	23'X20'	10'
402	50	15	36	13	46	40	460	23'X20'	10'
403/404	85	26	66	23	80	80	800	40'X20'	10'
403	36	12	21	21	36	30	360	20'X18'	10'
404	44	15	27	12	44	40	440	22'X20'	10'
405/406	110	33	75	29	100	100	1,000	50'X20'	10'
405	50	16	36	14	50	40	500	25'X20'	10'
406	50	16	36	14	50	40	500	25'X20'	10'
407	60	20	36	18	62	50	624	26'X24'	9'
Fifth Floor									
501/502	95	32	63	27	96	80	966	46'X21'	8'6"
501	48	16	30	14	48	40	483	23'X21'	8'6"
502	48	16	30	14	48	40	483	23'X21'	8'6"
503	42	14	24	12	42	30	420	20'x20'	8'6"
504	56	19	45	14	56	40	567	27'X21'	9'
508	36	12	18	10	36	20	360	20'X18'	8'9"
509/510	80	26	54	23	80	60	796	36'X22'	9'
509	40	13	27	11	40	30	450	25'X18'	9'
510	40	13	24	11	40	30	396	22'X18'	9'
Fifteenth Floor									
1503	50	18	27	16	55	40	550	23'X22'	8'6"
1505	50	17	27	15	53	40	528	23'X22'	8'10"
1508	N/A	7	N/A	N/A	N/A	N/A	120	10'X22'	10'5"



CROWNE PLAZA®

TIMES SQUARE MANHATTAN

Welcome to the Crowne Plaza Times Square Manhattan.

The new standard for service, luxury and comfort in midtown Manhattan. Our 795 renovated guest rooms feature the exclusive Crowne Plaza Sleep Advantage Program.

Located in the heart of the Theater District, the Crowne Plaza Times Square is the perfect base from which to take in a Broadway show, shop on Fifth Avenue, or stroll through Central Park. Every room has a stunning Times Square, Hudson River or City Skyline view. Dining options include Brasserie 1605, in-room dining and

Broadway 49 Bar & Lounge. On site fitness center – 29,000 square foot New York Sports Club, a dedicated conference and business center and state-of-the-art facilities including 25 function rooms and 23,000 sq. feet of flexible event space, some with views on Broadway. Dedicated Crowne Meetings Director, a CMP professional, assigned to your event.

Our \$85 million renovation was completed in 2008.

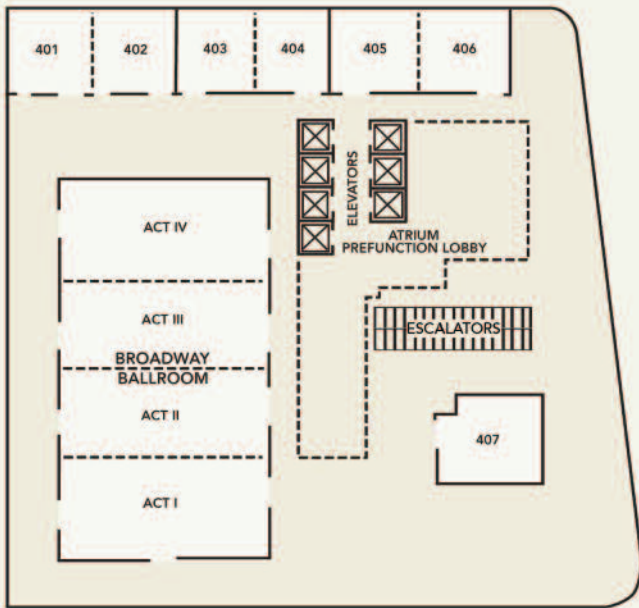

Fourth Floor

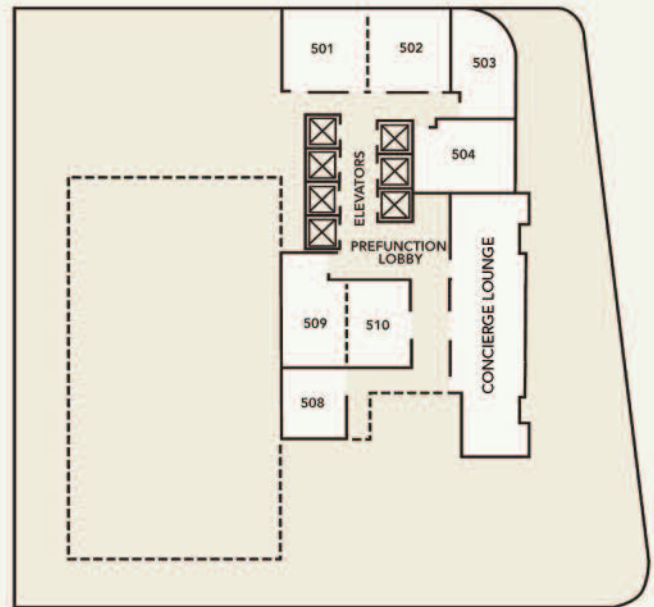

Fifth Floor

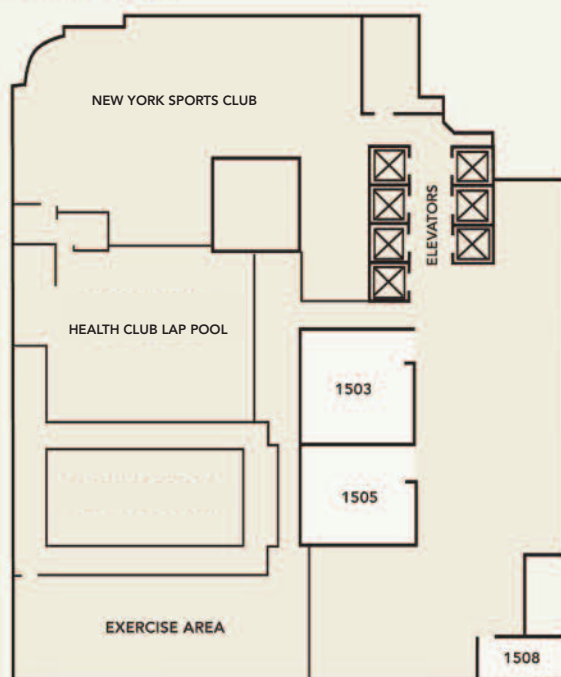

Fifteenth Floor

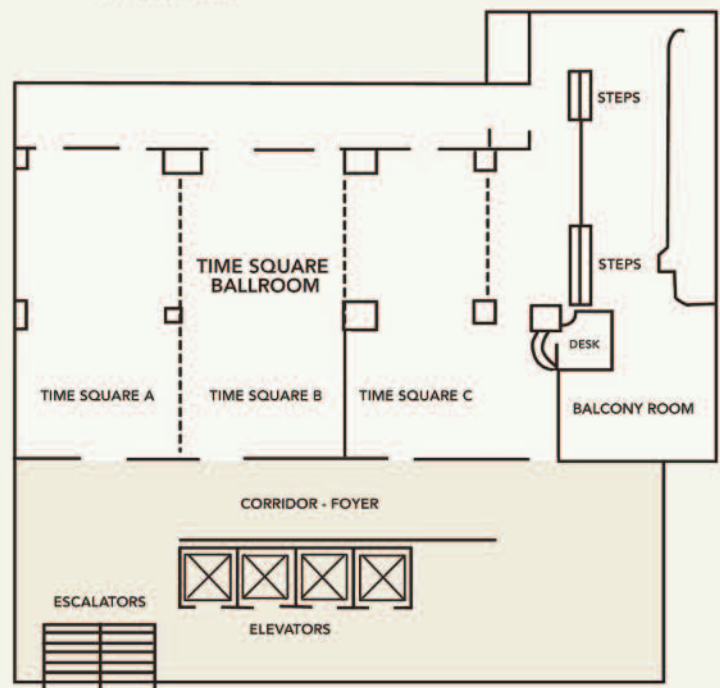

Times Square Ballroom